

Also from Sherpa



Garden Trolley



Electric Tiller



Powered Sprayer



Power Barrow

Poly Dump Cart



Owners Manual Model STPD

- Important Safety Instructions
- Assembly Instructions
- Parts and Hardware Identification

CAUTION: Read, understand and follow ALL instructions before using this product.

WARNING: Not for recreational use. Persons should never ride in the dump cart.

Questions, problems, or missing parts? Before returning to your retailer, visit us online at www.safetyliftinggear.com and complete the replacement parts submission form or call our customer service department at 0808 123 6969, 9am - 5pm Monday - Friday.

For product inquiries:
SafetyLiftinGear.com
Unit 23 Avonbridge Trading Estate
Atlantic Road
Avonmouth
Bristol, BS11 9QD
0808 123 69 69

Exploded Drawing for Assembly

Parts List

- A. Tray (1)
- B. Lock Assembly (1)
- C. Front Frame (1)
- D. Rear Axle Assembly (1)
(includes rear axle and left and right struts)
- E. Front Axle Assembly (1)
- F. 10 inch wheel (4)
- G. Handle (1)

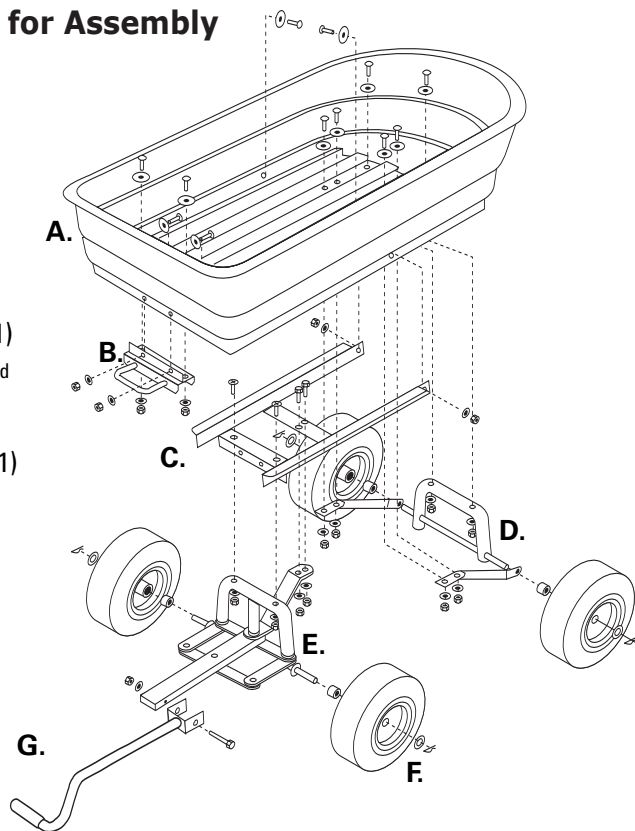

Using the Dumping Feature

To operate the dumping feature, pull the dumping release handle outward to release the plastic tray from the locking mechanism. Lift up the release handle to rotate cart upward into the dumping position.

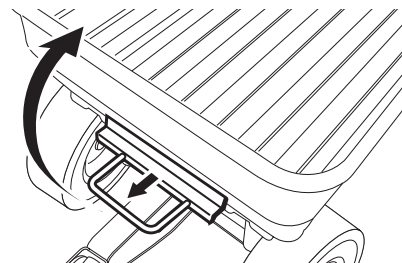

Returning the Plastic Tray to the Lowered Position

Rotate the plastic tray back down to the lowered position. Make sure the dumping release handle is locked into place when the cart is in the lowered position.



CAUTION

**DO NOT EXCEED MAXIMUM OVERALL LOAD CAPACITY 226 KG.
MAXIMUM DUMPING LOAD CAPACITY 113 KG.
WEIGHT RATING BASED ON EVENLY DISTRIBUTED LOAD.**

Replacement Parts List

For replacement parts, please visit us online at www.sherpatools.co.uk to complete the replacement parts submission form or call our customer service department on 0845 123 5844, 9am - 5pm, Monday - Friday.

Hardware List

Images are not to scale

- A. M8x60 Hex Head Bolt (1)
- B. M8x40 Phillips Flat Head Bolt (2)
- C. M8x45 Carriage Bolt (2)
- D. M8x20 Carriage Bolt (10)
- E. M8x20 Hex Head Bolt (2)
- F. M8 Lock Nut (17)
- G. M8 Washer (17)
- H. M11 Washer (12)
- I. M16 Washers (4)
- J. Cotter Pin (4)
- K. Wheel Spacers (4)

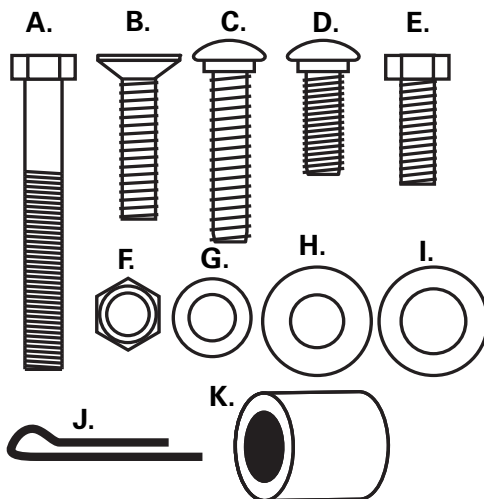

- B. Lock Assembly
- C. Front Frame
- D. Rear Axle Assembly
- E. Front Axle Assembly
- F. Tire
- G. Handle
- H. Hardware Kit

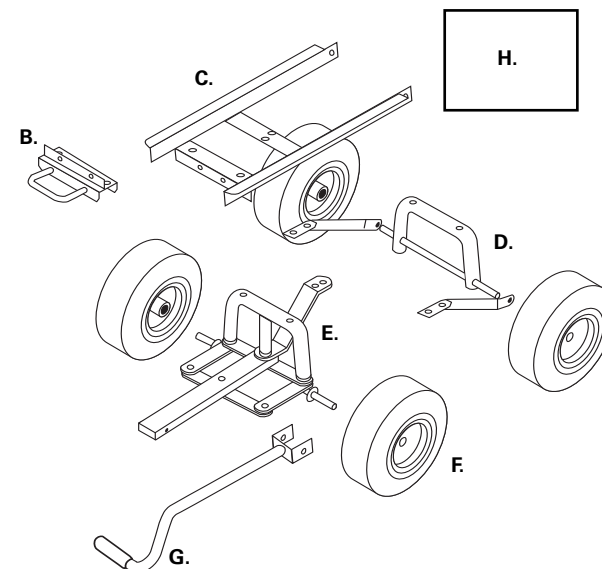

Important Safety Instructions

1. READ ALL INSTRUCTIONS CAREFULLY BEFORE USE. If you do not understand these instructions, need clarification or further explanation, please call our helpline for assistance on 0845 123 5844.
2. Do not load the cart with more than 226kg (500lb). Do not use the dumping feature of the cart with more than 113kg (250lb). The weight rating is based on an evenly distributed load.
3. Do not allow children to use the cart without supervision. This cart is not a toy.
4. Do not use this cart for transporting passengers.
5. This cart is not intended for highway use.
6. Do not exceed 5mph.
7. Do not load any items on the top edges of the tray.
8. If any parts become damaged, broken or misplaced, do not use this cart until replacement parts have been obtained.
9. Do not use this cart on surfaces or for transporting objects that can cause damage to the pneumatic tires or tubes.
Do not inflate the tires to more than 30 PSI (2.07 BAR).
10. It is recommended that the cart be inspected for damage before each use.
11. KEEP THESE INSTRUCTIONS FOR FURTHER REFERENCE.

Assembly Instructions

Your cart requires assembly. Account for all parts and hardware before beginning assembly. If any parts are missing, damaged or if you have any questions or need additional instructions DO NOT RETURN THIS PRODUCT TO THE RETAILER, please call our customer service department on 0845 123 5844.

Tools required for assembly: standard screwdriver,
Phillips screwdriver, pliers and socket set
(or two adjustable wrenches).

Note: During assembly of each step of assembly, assemble all hardware and hand tighten. Once all hardware is installed for this particular step, tighten all hardware.

Step 1

Locate the rear axle assembly (the left and right rear struts are pre-assembled to the rear axle frame as shown).

Step 2

Attach the rear axle assembly to the tray using M8x45 carriage bolts (2), M11 washers (2), M8 washers (2), and M8 lock nuts (2).

Attach the left and right rear struts to the tray using M8x20 carriage bolts (4), M11 washers (4), M8 washers (4), and M8 lock nuts (4).

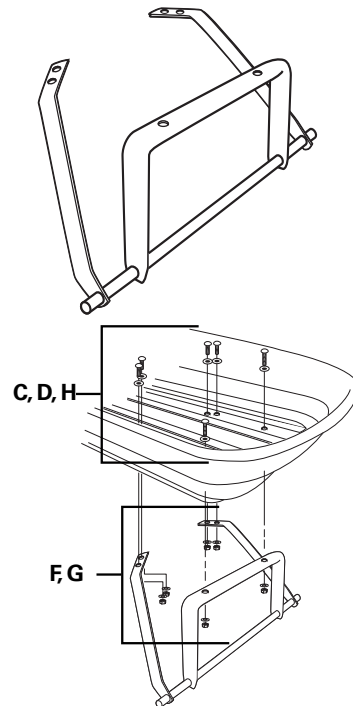

Step 3

Attach the dump lock assembly to the tray using M8x20 carriage bolts (4), M11 washers (4), M8 washers (4), and M8 lock nuts (4).

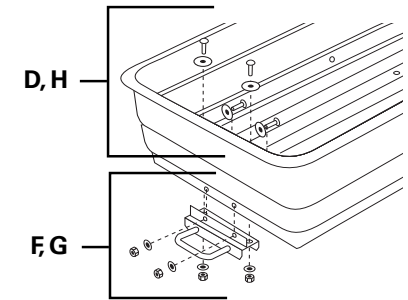

Step 4

Attach the front axle assembly to the front frame using M8x40 Phillips flat head bolts (2), M8 lock nuts (2), and M8 washers (2).

Attach the front axle support arm to the frame using M8x20 carriage bolts (2), M11 washers (2), M8 washers (2).

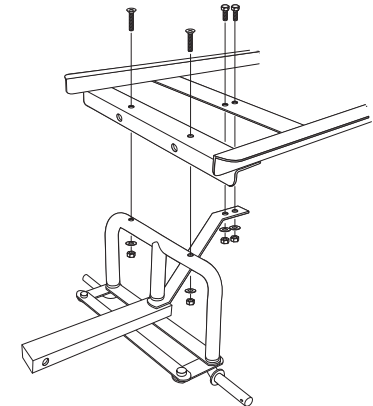

Step 5

Attach the frame to the tray using M8x20 carriage bolts (2), M11 washers (2), M8 washers (2), and M8 lock nuts (2).

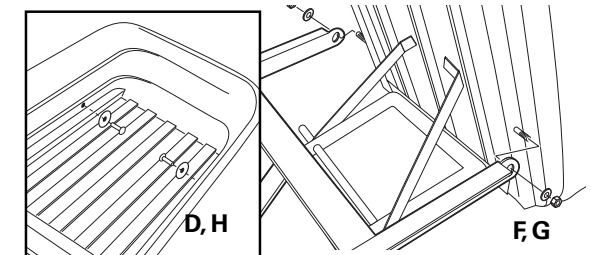

Step 6

Attach the wheels by first placing the wheel spacers (4) onto each axle, then placing the wheel (4) onto each axle and finally placing the wheel washers (4). Insert the cotter pins (4) into the hole at each end of the axles and bend back the ends of the cotter pins with pliers to keep them in place.

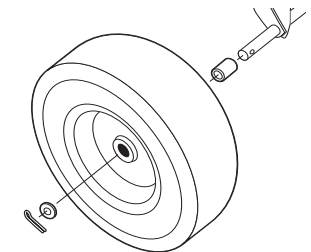

Step 7

Attach the handle to the yoke using M8x60 hex bolt (1), M8 lock nut (1), and M8 washer (1).

